

CEPTER

INSTRUCTION MANUAL

CEPTER 2.1ch Dolby Atmos Soundbar with Wireless Subwoofer

CBS555C



Thank you for purchasing your new CEPTER 2.1ch Dolby Atmos Soundbar with Wireless Subwoofer. We recommend that you spend some time reading this instruction manual in order that you fully understand all the operational features it offers. Read all the safety instructions carefully before use and keep this instruction manual for future reference.

Package Contents



Soundbar

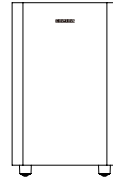

Wireless Subwoofer

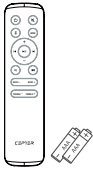

Remote Control /
AAA Batteries x 2

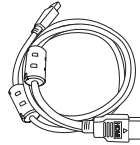

HDMI Cable



HDMI Extension
Cable



DC Adapter
(for Soundbar)



AC Power Cord
(for Subwoofer)

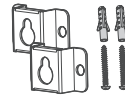

Wall mount kit



Silicone Feet
(Spare)

Product Overview

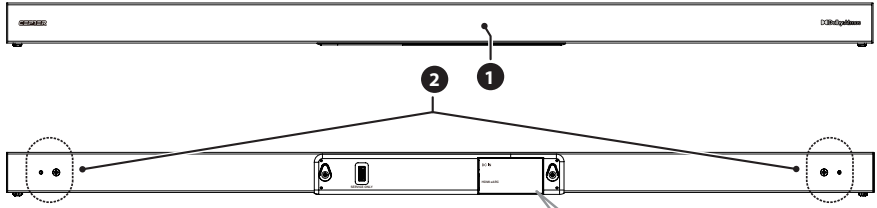

Soundbar

- ① LED Indicators / Remote Control Sensor

LED	Mode
• Red	Standby
• White	HDMI eARC/ARC
• Blue	BT (Bluetooth)

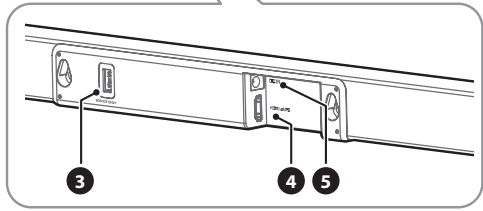

- ② Wall bracket screws
- ③ USB Socket (For update only)
- ④ HDMI eARC/ARC Socket
- ⑤ DC- Socket

Wireless Subwoofer



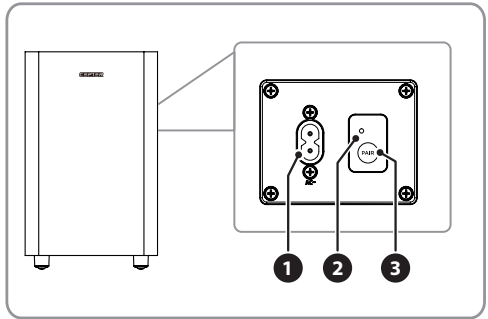



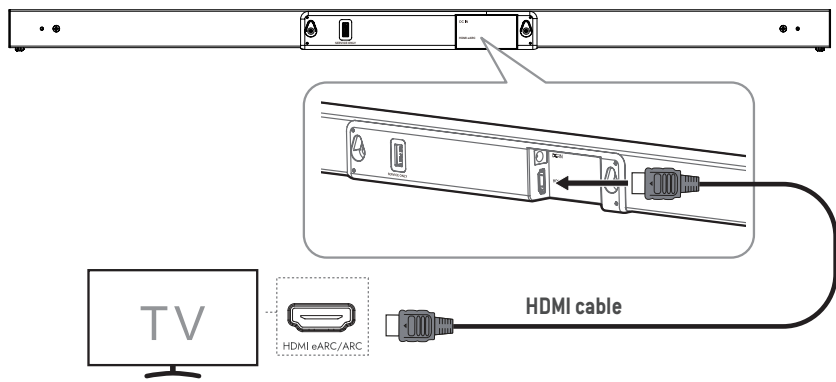

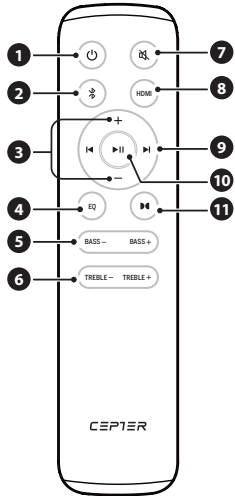

- ① AC~ Socket
- ② PAIR Indicator
- ③ PAIR button

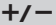

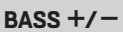
EXCEPT BT CONNECTION, AUDIO INPUT CAN BE WITH HDMI CABLE



Remote Control

①		Switch the Soundbar between ON and Standby mode.	
②		Select the Bluetooth mode. Press and hold to activate the pairing function in Bluetooth mode or disconnect the existing paired Bluetooth device.	
③		Increase/decrease the volume level.	
④		Select Equalizer (EQ) Effect.	
⑤		Increase or decrease the bass.	
⑥		Increase or decrease the treble.	
⑦		Mute or resume the sound.	
⑧		Select the HDMI eARC/ARC mode.	
⑨		Skip to previous /next track.	
⑩		Play/pause/resume playback.	
⑪		Turn the Dolby Atmos ON/OFF.	

Preparations Remote Control

- Open the rear cover & insert 2pcs AAA/R03, 1.5V batteries on correct polarity.
- Take out batteries if remote is not to be used in long time to avoid battery leakage.

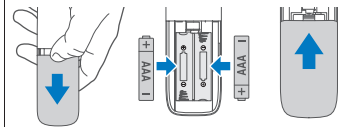

Placement and Mounting

Placement

NOTE: If the TV stand is shorter than the Soundbar and the Soundbar can not sit steadily on it, place the spare silicone feet between the existing ones and adjust their spacing to match the stand's length.

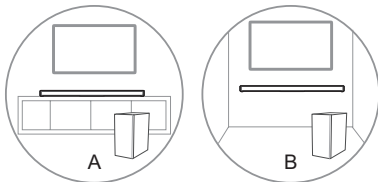

Wall Mounting (if using option-B)

NOTE: If you are unfamiliar with power tools or the layout of electrical wiring in the walls of your home, consult a professional installer.

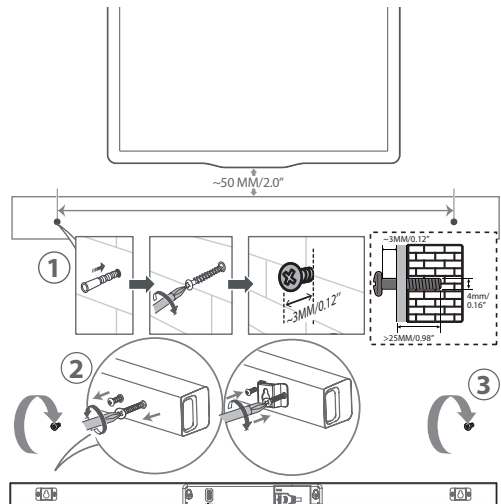



Dolby Atmos®

This Soundbar is equipped with a decoder that supports Dolby Atmos audio format.

Dolby Atmos® gives you immersive listening experience by delivering sound in three dimensional space, and all the richness, clarity, and power of Dolby sound. For more information, please visit dolby.com/technologies/dolby-atmos

Turn the Dolby Atmos ON/OFF

- Press the  button on the remote control to turn on the Dolby Atmos sound. (Flashing purple 3 times)
- Press the  button again to turn off the Dolby Atmos sound. (Flashing purple 2 times)

Connect Power

Ensure that the power supply voltage corresponds to the voltage printed on the back or the underside of the unit.

Soundbar: Insert the AC Adapter into the **DC IN** socket and switch on the Soundbar. The Soundbar will start searching the Subwoofer signal automatically.

Subwoofer: Insert the AC power cord into the **AC IN** socket and switch on. The Subwoofer will connect the Soundbar automatically.

Pair up with the Subwoofer

The Subwoofer and Soundbar will automatically pair when both units are plugged into the mains sockets and turned on. No cable is needed for connecting the two units.

- Determine the status based on the Subwoofer indicator.

LED State	Status
Fast blink	Subwoofer in pairing mode
Constant on	Connected / Pairing successful
Slow blink	Connection / Pairing Failed

Don't press **PAIR** button as Soundbar and Subwoofer would be paired automatically after the unit is switched ON.

NOTE:

In case of a problem, press and hold the **PAIR** button on the Subwoofer and the Pair Indicator will blink quickly, then press and hold the  (MUTE) button on the remote control to manually pair.

Select Equalizer (EQ) Effect

While playing, press the **EQ** button on the remote control to select desired preset equalizers.

MOVIE: recommended for viewing movies.

NEWS: recommended for listening to News.

MUSIC: recommended for listening to music.

SOUND MODE	LED
MOVIE	Flashing Cyan 2 times
NEWS	Flashing yellow 2 times
MUSIC	Flashing Purple 2 times

Automatic Power Off Function

The SoundBar automatically turns to **Standby** mode after about **15** minutes if the TV or the external device is disconnected, or if Bluetooth playback is paused.

HDMI Operation

1. Ensure that the Soundbar is connected to the TV or audio device.
 2. Press the **HDMI** button on the remote control to select the **HDMI eARC/ARC** mode.
 3. Operate your audio device directly for playback features.
 4. Press the **+/-** (VOL) button to adjust the volume to your desired level.
- When selecting a different audio format, the Soundbar will display the following as follows.

Audio(abbreviation)	LED State
PCM	NO LED flashing
Dolby ATMOS	Flashing blue 4 times
Dolby AUDIO	Flashing green 4 times

Bluetooth® Operation

Pairing the Soundbar with a Bluetooth® device to listen to music:

First time pairing

1. Press press **⌘** button on the remote control to select **Bluetooth** mode. The Blue indicator will flash slowly.
2. On the Bluetooth device, switch on Bluetooth, search for and select "**CBS555C**" to start connection.
3. Wait until you hear the voice prompt from the Soundbar.
4. Select and play audio files or music on your Bluetooth device.

Pairing a new device after first time pairing:

In Bluetooth® mode, press and hold the **⌘** button to disconnect from current Bluetooth connected devices and enter the Bluetooth pairing mode. Follow step 2-3 to pair your Bluetooth device.

NOTE:

Compatibility with all Bluetooth devices is not guaranteed.

Troubleshooting





To keep the warranty valid, never try to repair the system yourself. If you encounter problems when using this Soundbar, check the following points before requesting service.

Problem	Solution
No power	<ul style="list-style-type: none"> • Ensure that the AC cord of the apparatus is properly connected . • Ensure that there is power at the AC outlet. • Press ⏻ (standby) button to turn the Soundbar on.
Remote control does not work	<ul style="list-style-type: none"> • Before you press any playback control button, first select the correct source. • Reduce the distance between the remote control and the Soundbar. • Insert the battery with its polarities [+/ -] aligned as indicated. • Replace the battery. • Aim the remote control directly at the sensor on the front of the Soundbar.
No sound	<ul style="list-style-type: none"> • Make sure that the Soundbar is not muted. Press MUTE or volume +/- (VOL) button to resume normal listening. • Press ⏻ button on the remote control to switch the Soundbar to standby mode. Then press the ⏻ button on the remote control again to switch the Soundbar on. • Unplug both the Soundbar and the Subwoofer from the mains socket, then plug them again. Switch on the Soundbar. • Ensure the audio setting of the input source (e.g. TV, game console, DVD player, etc.) is set to PCM or Dolby Digital mode while using digital (e.g. HDMI) connection. • The Subwoofer is out of range, please move the Subwoofer closer to the Soundbar. Make sure the Subwoofer is within 5 m of the Soundbar (the closer the better). • The Soundbar may have lost connection with the Subwoofer. Re-pair the units by following the steps on the section “ Pair up with the Subwoofer ”. • The Soundbar may not be able to decode all digital audio formats from the input source. In this case, the Soundbar will mute. This is NOT a defect device is not muted.
TV has display problem while viewing HDR content from HDMI source:	<p>• Some 4K HDR TVs require the HDMI input or picture settings to be set for HDR content reception. For further setup details on HDR display, please refer to the instruction manual of your TV.</p>
I can't find the Bluetooth name of this Soundbar on my Bluetooth device for Bluetooth pairing	<ul style="list-style-type: none"> • Ensure the Bluetooth function is activated on your Bluetooth device. • Re-pair the Soundbar with your Bluetooth device. • The Soundbar has a Bluetooth[®] function that can receive a signal within 8 metres. Keep a distance within 8 metres between the Soundbar and your Bluetooth[®] device.
The Soundbar turns off	<ul style="list-style-type: none"> • When the unit's external input signal level is too low, the Soundbar will be turned off automatically in 15 minutes. Please increase the volume level of your external device.
Can't achieve outstanding Dolby Atmos[®] effects.	<ul style="list-style-type: none"> • For non-HDMI connections (such as use of Bluetooth, OPTICAL or AUDIO IN), limited height Surround effects are generated. See the section of ‘Dolby Atmos[®]’ about how to achieve best Dolby Atmos[®] effects.

Specifications

Brand	CEPTER
Model	CBS555C

Soundbar

Adapter Mode	KA3601A-2401500DE	 
Input	100-240 V~ 50/60 Hz	
Output	24 V \equiv 1.5 A  	
Power Consumption	30 W < 0.5 W (StandBy)	
USB (service only)	5 V \equiv 500 mA	
Dimension (WxHxD)	800 x 40 x 35 mm	
Net weight	0.7 kg	
Audio input sensitivity	500 mV	
Frequency Response	120 Hz - 20 KHz	

Wireless Specification

Bluetooth version / profiles	V5.3 (A2DP, AVRCP)
Bluetooth frequency range	2400 MHz ~ 2483.5 MHz
Bluetooth Max. transmitting power	\leq 5 dBm
2.4G Wireless frequency range	2400 MHz ~ 2483 MHz
2.4G Max. transmitting power	\leq 6 dBm
Modulation Type	GFSK, $\pi/4$ DQPSK

Subwoofer

Power Supply	100-240 V~ 50/60 Hz
Power Consumption	30 W < 0.5 W (StandBy)
Dimension (WxHxD)	195 x 320 x 195 mm
Net weight	2.95 kg
Frequency Response	40 Hz - 120 Hz

Amplifier (RMS Output power)

Total	240 W Maximum/Peak/Reference/Music Power (approx.) 120 W (RMS Power @ 10% THD (W))
Soundbar	30 W (8 Ω) + 30 W (8 Ω)
Subwoofer	60 W (4 Ω)

Remote Control

Distance/Angle	19.7 feet (6 m) / 30°
Battery type	R03 AAA (1.5 V x 2)

- Design and specifications are subject to change without notice.

CARE AND MAINTENANCE

1. Do not subject the unit to excessive force, shock, dust or extreme temperature.
2. Do not tamper with the internal components of the unit.
3. Clean the unit with a damp [never wet] cloth except metal contact or speaker grille. Solvent or detergent should never be used.
4. Avoid leaving your unit in direct sunlight, humid or dusty or extreme cold/hot places. Keep your unit away from heating appliances and sources of electrical noise.
5. Do not install or place this unit in a bookcase, built-in cabinet or conned space. Ensure the unit is well ventilated.
6. Un-plug the unit from the mains socket after used or lightning storm or while cleaning.
7. Do not open any xed covers as this may expose dangerous voltages.

Battery Specifications



Type: R03 AAA 1.5V

Weight: Approx 10.5g

Chemical System: Zn-MnO₂ (KOH). Non-rechargeable.

Capacity: 400mAh,0.6Wh (Load 75Ω to 0.9V), loading at 75Ω discharge, 4 hour per day, till the voltage down to 0.9V

Critical raw materials: Zinc, Manganese Dioxide.

Hazardous substances: mercury, cadmium and lead: Not added.

Applicable fire extinguishers: Dry powder fire extinguishers, carbon dioxide fire extinguishers

DONGGUAN TIANQIU ENTERPRISE CO., LTD

TianQiu Industrial Park, Xinji Industrial Zone, Machong Town, Dongguan, GuangDong, P.R.China

Made in China

WARNING: DO NOT RECHARGE. DO NOT DISPOSE OF IN FIRE. INSERT CORRECTLY (+/-).

Notes for battery disposal

The batteries used on remote control contain chemicals that are harmful to the environment.

To preserve our environment, dispose of used batteries according to your local laws or regulations. Do not dispose of batteries with normal household waste.

For more information, please contact the local authority or your retailer where you purchased the product.

CAUTION: Never allow any water or other liquids to get inside the unit while cleaning.



This symbol on the product or in the instructions means that your electrical and electronic equipment should be disposed at the end of its life separately from your household waste. There are separate collection systems for recycling in the EU.

For more information, please contact the local authority or your retailer where you purchased the product.



Dolby, Dolby Atmos, and the double-D symbol are registered trademarks of Dolby Laboratories Licensing Corporation. Manufactured under license from Dolby Laboratories. Confidential unpublished works. Copyright © 2012-2024 Dolby Laboratories. All rights reserved.

The Bluetooth® word mark and logos are registered trademarks owned by Bluetooth SIG, Inc. and any use of such marks by Zhong Shan City Richsound Electronic Industrial Ltd is under license. Other trademarks and trade names are those of their respective owners.

The terms HDMI, HDMI High-Definition Multimedia Interface, HDMI trade dress and the HDMI Logos are trademarks or registered trademarks of HDMI Licensing Administrator, Inc.

EN

Power International AS,
 PO Box 523, 1471 Lørenskog, Norway
 Power Norge:
<https://www.power.no/kundeservice/>
 T: 21 00 40 00
 Expert Danmark:
<https://www.expert.dk/kundeservice/>
 T: 70 70 17 07
 Power Danmark:
<https://www.power.dk/kundeservice/>
 T: 70 33 80 80
 Punkt 1 Danmark:
<https://www.punkt1.dk/kundeservice/>
 T: 70 70 17 07
 Power Finland:
<https://www.power.fi/tuki/asiakaspalvelu/>
 T: 0305 0305
 Power Sverige:
<https://www.power.se/kundsservice/>
 T: 08 517 66 000

NO

Power International AS,
 Postboks Box 523, 1471 Lørenskog, Norge
 Power Norge:
<https://www.power.no/kundeservice/>
 T: 21 00 40 00
 Expert Danmark:
<https://www.expert.dk/kundeservice/>
 T: 70 70 17 07
 Power Danmark:
<https://www.power.dk/kundeservice/>
 T: 70 33 80 80
 Punkt 1 Danmark:
<https://www.punkt1.dk/kundeservice/>
 T: 70 70 17 07
 Power Finland:
<https://www.power.fi/tuki/asiakaspalvelu/>
 T: 0305 0305
 Power Sverige:
<https://www.power.se/kundsservice/>
 T: 08 517 66 000

FI

Power International AS,
 PO Box 523, 1471 Lørenskog, Norway
 Power Norjassa:
<https://www.power.no/kundeservice/>
 P: 21 00 40 00
 Expert Tanskassa:
<https://www.expert.dk/kundeservice/>
 P: 70 70 17 07
 Power Tanskassa:
<https://www.power.dk/kundeservice/>
 P: 70 33 80 80
 Punkt 1 Tanskassa:
<https://www.punkt1.dk/kundeservice/>
 P: 70 70 17 07
 Power Suomessa:
<https://www.power.fi/tuki/asiakaspalvelu/>
 P: 0305 0305
 Power Ruotsissa:
<https://www.power.se/kundsservice/>
 P: 08 517 66 000

DK

Power International AS,
 PO Box 523, 1471 Lørenskog, Norway
 Power Norge:
<https://www.power.no/kundeservice/>
 T: 21 00 40 00
 Expert Danmark:
<https://www.expert.dk/kundeservice/>
 T: 70 70 17 07
 Power Danmark:
<https://www.power.dk/kundeservice/>
 T: 70 33 80 80
 Punkt 1 Danmark:
<https://www.punkt1.dk/kundeservice/>
 T: 70 70 17 07
 Power Finland:
<https://www.power.fi/tuki/asiakaspalvelu/>
 T: 0305 0305
 Power Sverige:
<https://www.power.se/kundsservice/>
 T: 08 517 66 000

SE

Power International AS,
 PO Box 523, 1471 Lørenskog, Norge
 Power Norge:
<https://www.power.no/kundeservice/>
 T: 21 00 40 00
 Expert Danmark:
<https://www.expert.dk/kundeservice/>
 T: 70 70 17 07
 Power Danmark:
<https://www.power.dk/kundeservice/>
 T: 70 33 80 80
 Punkt 1 Danmark:
<https://www.punkt1.dk/kundeservice/>
 T: 70 70 17 07
 Power Finland:
<https://www.power.fi/tuki/asiakaspalvelu/>
 T: 0305 0305
 Power Sverige:
<https://www.power.se/kundsservice/>
 T: 08 517 66 000

